

Q

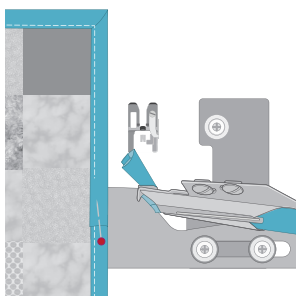

R

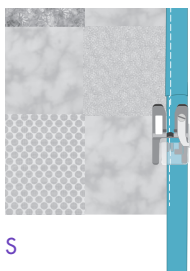

S

## HOW TO FINISH THE BINDING:

1. **Sew** the binding all the way around the quilt edges.
2. When the edges of the binding almost meet, **cut** the excess fabric at the starting point of the of binding. (Illustration Q)
3. Continue to **sew**, overlapping the binding one more time.
4. **Remove** the quilt from the binder and **trim** excess binding leaving a 1" (2.5) cm tail. **Fold** back the opening and **pin** in place. (Illustration R)
5. **Sew** a seam over the folded edge. (Illustration S)

### Contents

1. Quilt Binder
2. Quilt Foot
3. Attachment Plate
4. Thumbscrews & Washers

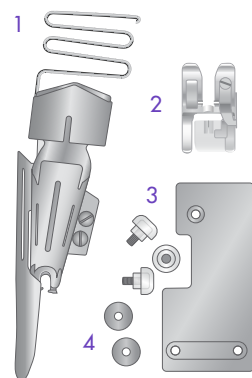

### Language information:

**DE** Die Bedienungsanleitung auf Deutsch können Sie unter [www.pfaff.com](http://www.pfaff.com) herunterladen. Suche nach "quilt binder" unter der Überschrift "Zubehör".

**DK** En dansk brugervejledning kan downloades fra [www.pfaff.com](http://www.pfaff.com). Søg efter "quilt binder" under overskriften "Ekstratillbehør".

**ES** Las instrucciones de uso en español están disponibles para su descarga en [www.pfaff.com](http://www.pfaff.com). Buscar "quilt binder" en el apartado "Accesorios".

**FR** Un mode d'emploi en français peut se télécharger sur [www.pfaff.com](http://www.pfaff.com). Rechercher "quilt binder" sous le titre "Accessoires".

**IT** Le istruzioni d'uso in italiano sono disponibili per lo scarico da [www.pfaff.com](http://www.pfaff.com). Cerca in "quilt binder" sotto il titolo "Accessori".

**NL** Nederlands gebruiksinstructies kunnen worden gedownload op [www.pfaff.com](http://www.pfaff.com). Zoeken naar "quilt binder" onder de kop "Accessoires".

**NO** Norsk bruksanvisning er tilgjengelig for nedlasting fra [www.pfaff.com](http://www.pfaff.com). Søk etter "quilt binder" under overskriften "Ekstratillbehør".

**RU** Инструкции по эксплуатации на русском языке можно загрузить на веб-сайте [www.pfaff.com](http://www.pfaff.com). Искать "quilt binder" под заголовком "Принадлежности".

**SO** Suomenkieliset käyttöohjeet ovat ladattavissa osoitteessa [www.pfaff.com](http://www.pfaff.com). Etsiä "quilt binder" otsikolla "Lisätarvikkeet".

**SV** Användarinstruktioner på svenska finns att hämta på [www.pfaff.com](http://www.pfaff.com). Sök efter "quilt binder" under rubriken "Tillbehör".

### Machine code:

J\*, L

\*When used with needle plate 412964309

## QUILT BINDER

### Double Fold 1/2" (12mm) Binder

The Double Fold 1/2" (12mm) binder will turn a lightweight woven fabric strip into a binding and attach it to the project edges all in one step.

To bind edges with 1/2" (12mm) Quilt Binder, cut a 1 3/4" (45mm) wide strip of lightweight woven fabric.

## HOW TO START WITH YOUR QUILT BINDER SETUP:

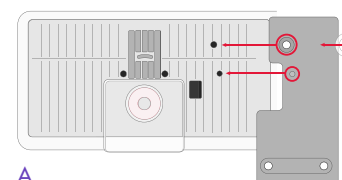

A

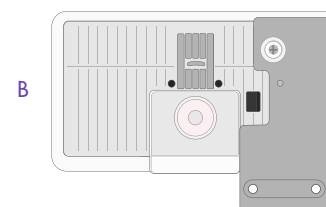

B

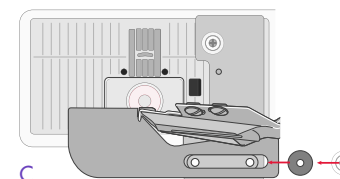

C

1. **Attach** the Quilt Binder Foot and engage the IDT. **Set** the machine for straight stitch or hand look quilt stitch.

**Place** the attachment plate on the stitch plate of the machine. **Align** pin on the back of attachment plate to the top opening on the stitch plate of the machine. **Screw** the attachment plate in place with one thumb screw. (Illustrations A, B)

2. **Place** the binder on the attachment plate. (Illustration C)

Part number: 471056296

PFAFF is an exclusive trademark of Singer Sourcing Limited LLC. ©2019 Singer Sourcing Limited LLC. All rights reserved.

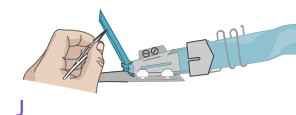
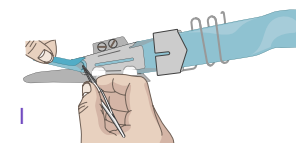
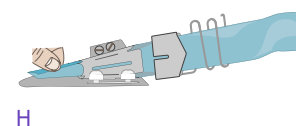
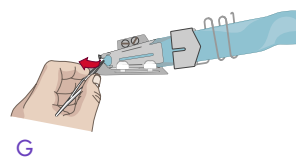
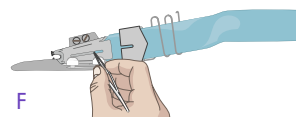
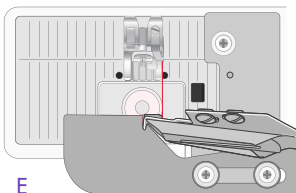
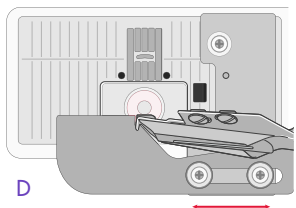

3. **Adjust** the binder to line up as shown. **Attach** the binder in place with the two thumb screws and washers. (Illustration D, E)

4. **Measure** the length of your project and add at least 6" (15cm). **Cut** enough 1 3/4" (45mm) strips to equal that number and join the strips together as follows: **Place** two strips with right sides together at a 90-degree angle. **Sew** the strips together at a 45-degree angle across the diagonal. **Trim** seam allowance and press open. **Cut** the end of the strip into a point.

5. **Place** the pointed edge of the fabric strip in the metal guide as illustrated. Using tweezers, **slide** the fabric strip into the binder with the wrong side facing you. (Illustrations F, G)

6. When the fabric is through the end of the binder, **hold** the folded strip with your left hand and continue to feed it into the binder while the fabric forms a double-fold tape. (Illustrations H, I, J)

7. **Raise** the presser foot and pull the strip under the foot and straight back 2.5" (5-6cm) behind the needle. (Illustration K)

8. **Slide** the fabric to be bound right-side up into the slot of the binder, using tweezers if necessary. To ensure an attractive finish to the binding, **start** to sew in the middle of one side of the quilt. **Sew** a few stitches to see if the seam is in desired position. **Adjust** the stitch position to right or left to reach the desired needle position. Test sew a sample before sewing your project. (Illustration L)

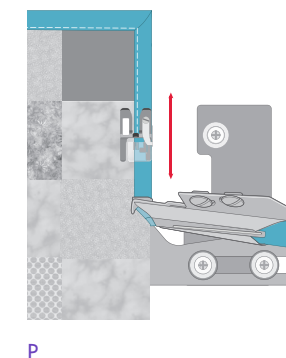
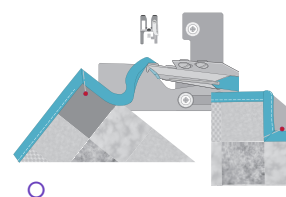
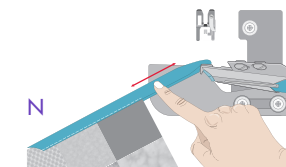
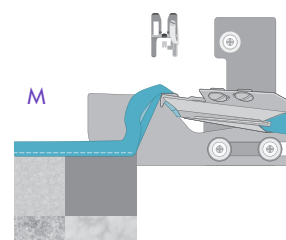
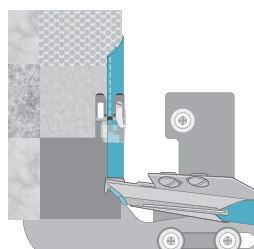
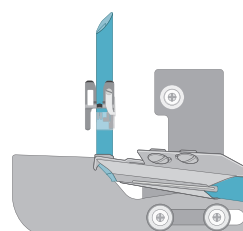

## HOW TO SEW A QUILT BINDER CORNER:

1. **Sew** to the edge of the quilt, tie off and then **pull** the quilt out from binder. Keep the quilt close to the binder when folding the corners. (Illustration M)

2. Finger **press** the folded fabric. (Illustration N)

3. To create a mitered corner: **Fold** and **pinch** the top mitered corner, **pin** in place with a long pin. **Repeat** in the same way on the back of the quilt. (Illustration O)

4. To continue sewing the binding, **pull** the fabric strip back through the binder and at the same time **place** the quilt back under the presser foot and into the binder again.

*Tip! Raise the presser foot to the highest position and the feed dogs will drop and create space for pulling the quilt under the presser foot.*

5. To insure that the fold is right on both top and back, **pull** the quilt forward and back again a couple of times.

6. **Lower** the needle to hold the binding in place and **remove** the pins. **Pull** out long thread tails behind the presser foot before starting to sew. **Backstitch** and **sew** the binder in place. (Illustration P)

7. Repeat on the other corners.

*Tip! Use the long thread tails to join the mitered corners.*